

8-32 UNC - ∇ 8mm

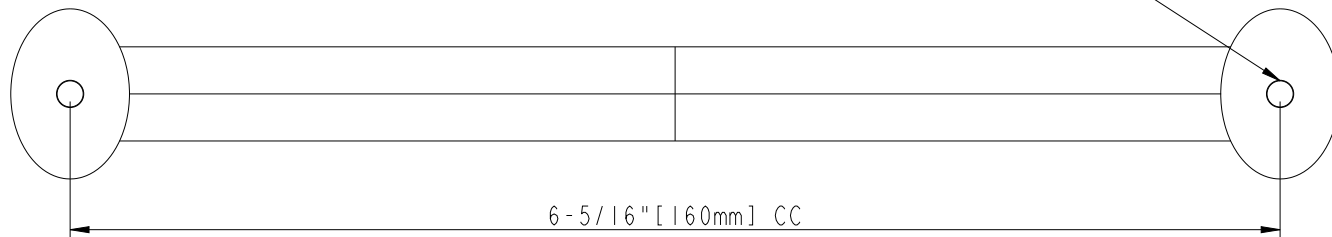

6-5/16" [160mm] CC

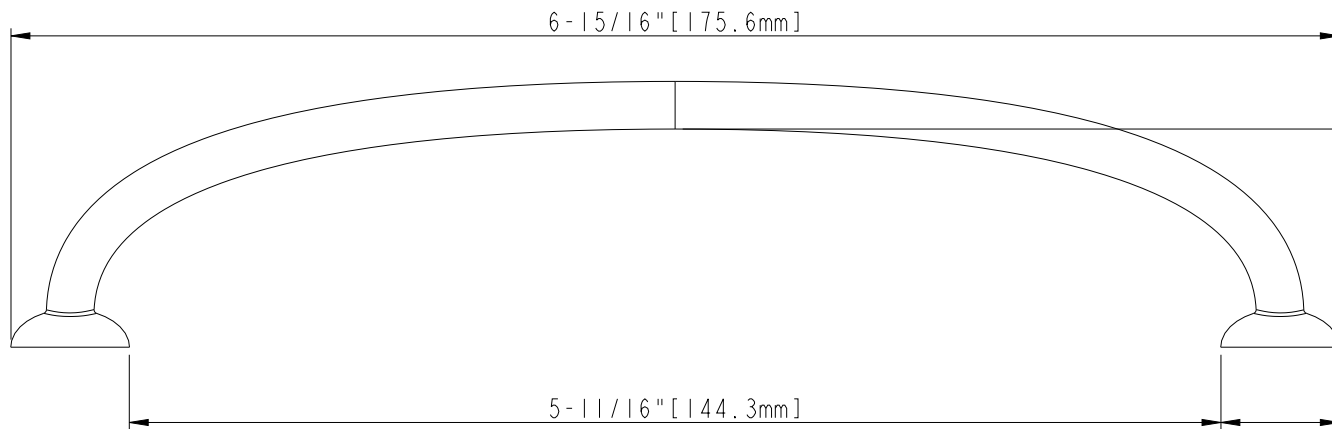

6-15/16" [175.6mm]

1-1/8" [28.9mm]

5-11/16" [144.3mm]

5/8" [15.7mm]

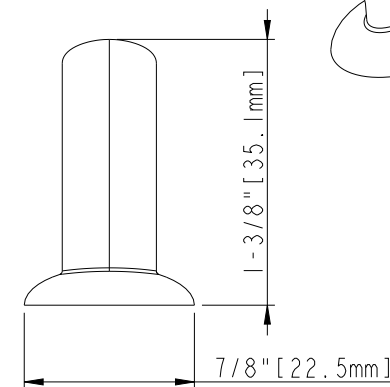
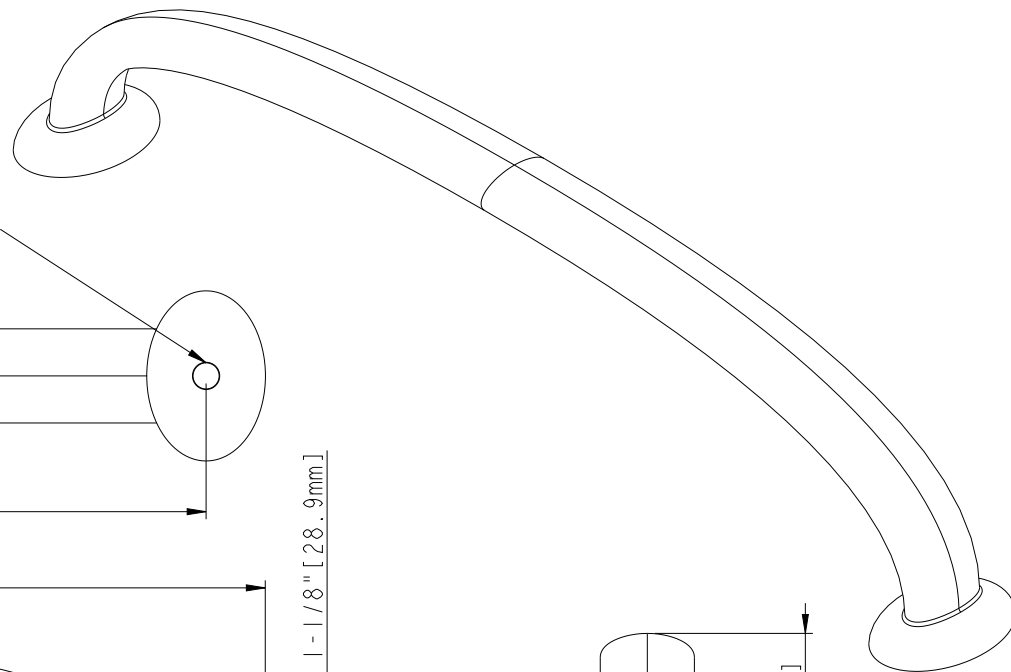

1-3/8" [35.1mm]

7/8" [22.5mm]

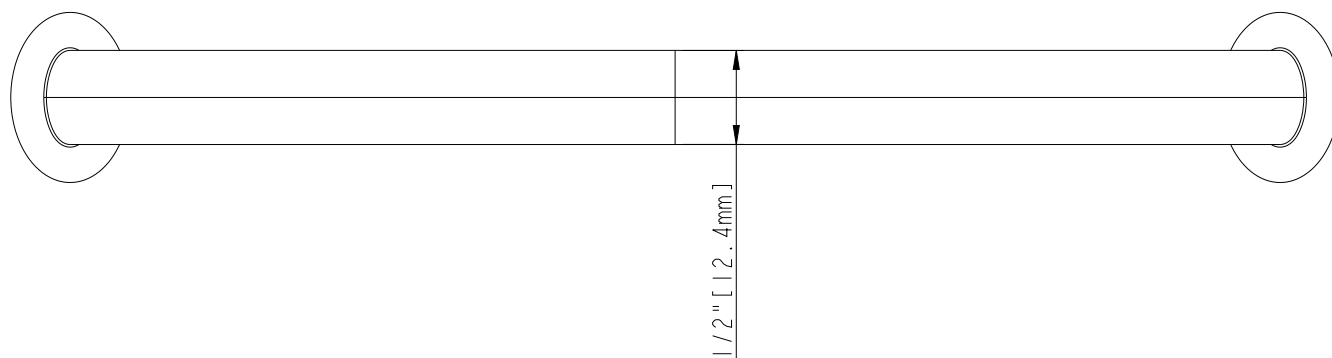

1/2" [12.4mm]

ACCESSORY:
 SCREW: 8-32x1" 2PCS
 BREAK AWAY SCREW: 8-32x45 2PCS
 ALL SCREW MATERIAL: STEEL-SAE1006

| | | |
|---|---|---|
| | ITEM#: 650-160 | MATERIAL: Zamak 3 |
| | WEIGHT: 83.9g/0.184lbs | PROJECTION |
| PROPRIETARY AND CONFIDENTIAL THE INFORMATION CONTAINED IN THIS DRAWING IS THE SOLE PROPERTY OF HARDWARE RESOURCES INC. ANY REPRODUCTION IN PART OR AS A WHOLE WITHOUT THE WRITTEN PERMISSION OF HARDWARE RESOURCES INC. IS PROHIBITED. | TOLERANCE UNLESS OTHERWISE SPECIFIED: X ±0.20 X.X ±0.10 X.XX ±0.05 ANGULAR: ±0.5° | UNITS: DRAWN BY: Alexander.W DATE: Dec-17-20 SIZE: APPROVED BY: DATE: SHEET: RELEASE LEVEL: REVISION: |
| DO NOT SCALE DRAWING | | |